

Great, hand winch can be used in so many ways !

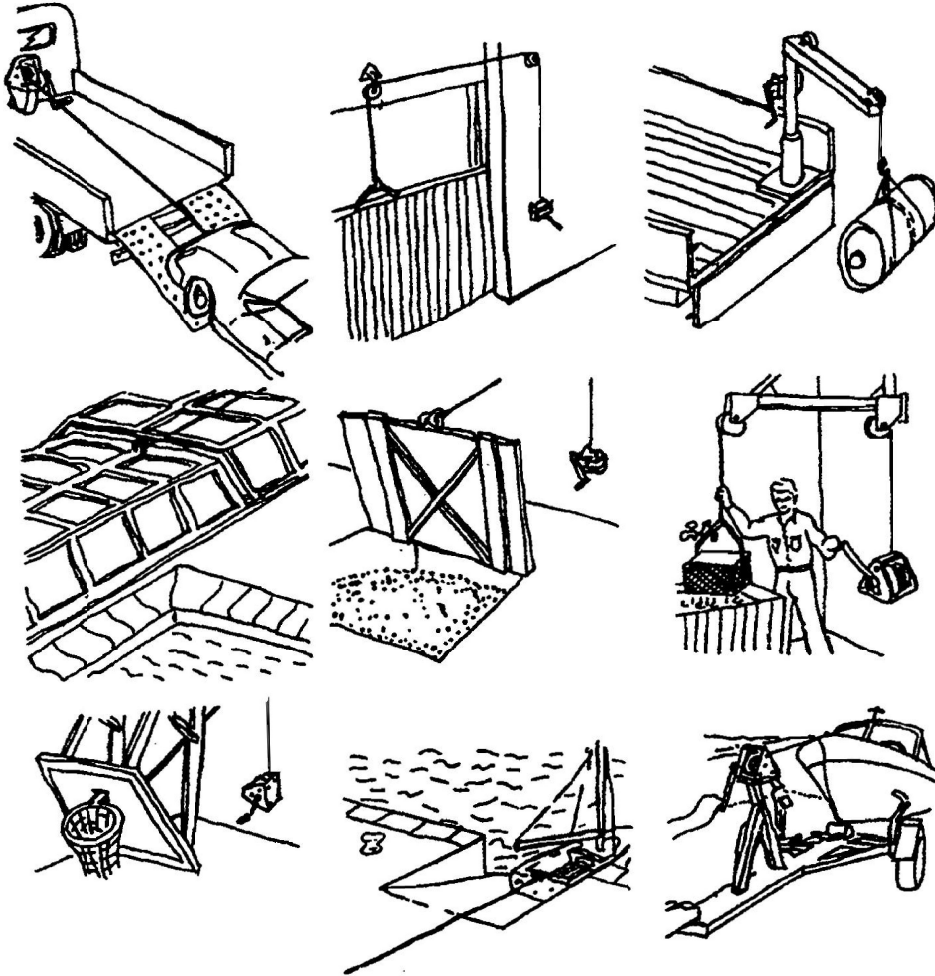

BEFORE USE

Firmly secure the winch to its plane.

Use only the rope type recommended on the nameplate and observe the winding direction shown by the arrow.

Never disengage the winch when loaded.

Always keep 3 turns of rope around the drum.

Periodically lubricate the gears.

Prohibitions for use:

Lift loads exceeding the rated load specified on the plate of the appliance;

unwind the drum completely (keep 2 to 3 extra-turns);

pull sideways, swing the load, use the winch to lift staff, go under the load;

use damaged or spliced ropes;

use hooks without catches, not suitable for the loads specified on the appliance or in bad condition;

insert objects into the moving parts;

take action on appliance under load;

release the drum under load;

allow the load to fall freely;

motorize the appliances;

use the rope of the appliance as a sling;

Statutory, compulsory checks by the user

This equipment has been designed to withstand the following tests;

Dynamic proof test at coefficient 1.1

Static proof test at coefficient 1.5

A periodic maintenance check is required once a year.

Check the wear of the brake linings regularly.

Putting out of operation

When the equipment is in a state of decay likely to create risks, the user is obliged to do away with this material i.e. put it out of operation, dismantle it if required.

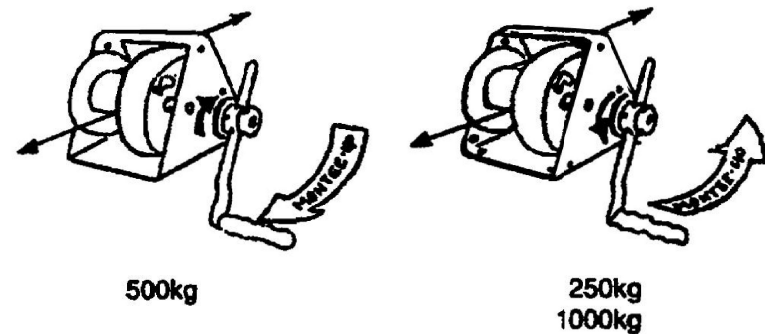

GR SERIES PARTS LIST

1	Screw M5x12	20	Circlip 8
2	Frame	21	Hander
3	Cover& rivet	22	Crank
4	Pin 3.2x22	23	Knob
5	Lever	24	Circlip 6
6	Gear wheel	25	Crank head
7	Spring	26	Spring pin $\Phi 8 \times 25$
8	Release pin	27	Pin 4x20
9	Drum	28	Front bearing
10	Cable clamp	29	Lock washer
11	Nut M4	30	Friction disc
12	Spring pin 6x35	31	Bush
13	Shaft	32	Ratchet wheel
14	Shim	33	Friction disc
15	Washer	34	Support washer
16	Brass bushing	35	Circlip 12
17	Pawl Pin	36	Shaft pinion
18	Pawl spring	37	Retainer collar
19	Pawl	38	Circlip 28

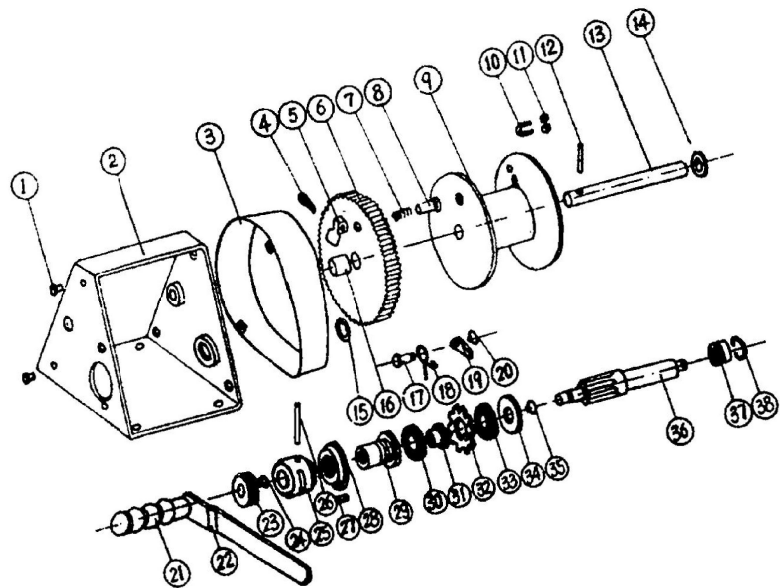

VS SERIES PARTS LIST

1	Frame	20	Pawl
2	Cover	21	Pawl pin
3	Screw	22	Hander
4	Washer	23	Crank
5	Inner hexagonal screw	24	Knob
6	Worm wheel	25	Circlip 6
7	Drum	26	Crank head
8	Cable clamp	27	Pin
9	Nut M4	28	Front bearing
10	Nut	29	Washer
11	Spring pin	30	Circlip
12	Shaft	31	Shaft pinion
13	Washer	32	Friction disc
14	Spring pin	33	Ratchet wheel
15	Weld washer(bottom)	34	Rear bearing
16	Weld washer(side)	35	Brass bushing
17	Spring pin		
18	Circlip		
19	Pawl sping		

